

MOWER TYPE XRM 235 FOR OMEGA
 SPARE PARTS DRAWING

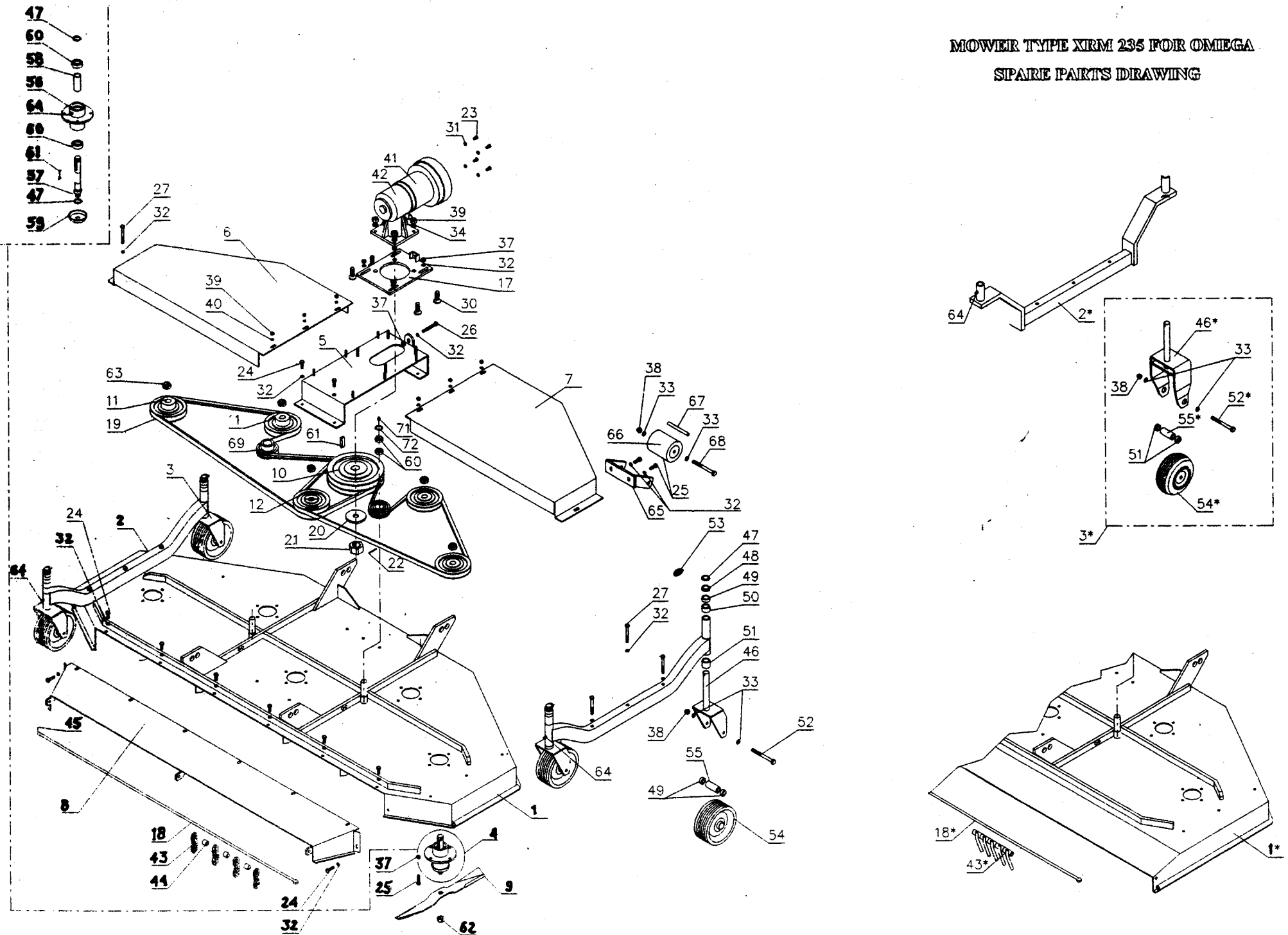

OMEGA IN WORKING POSITION

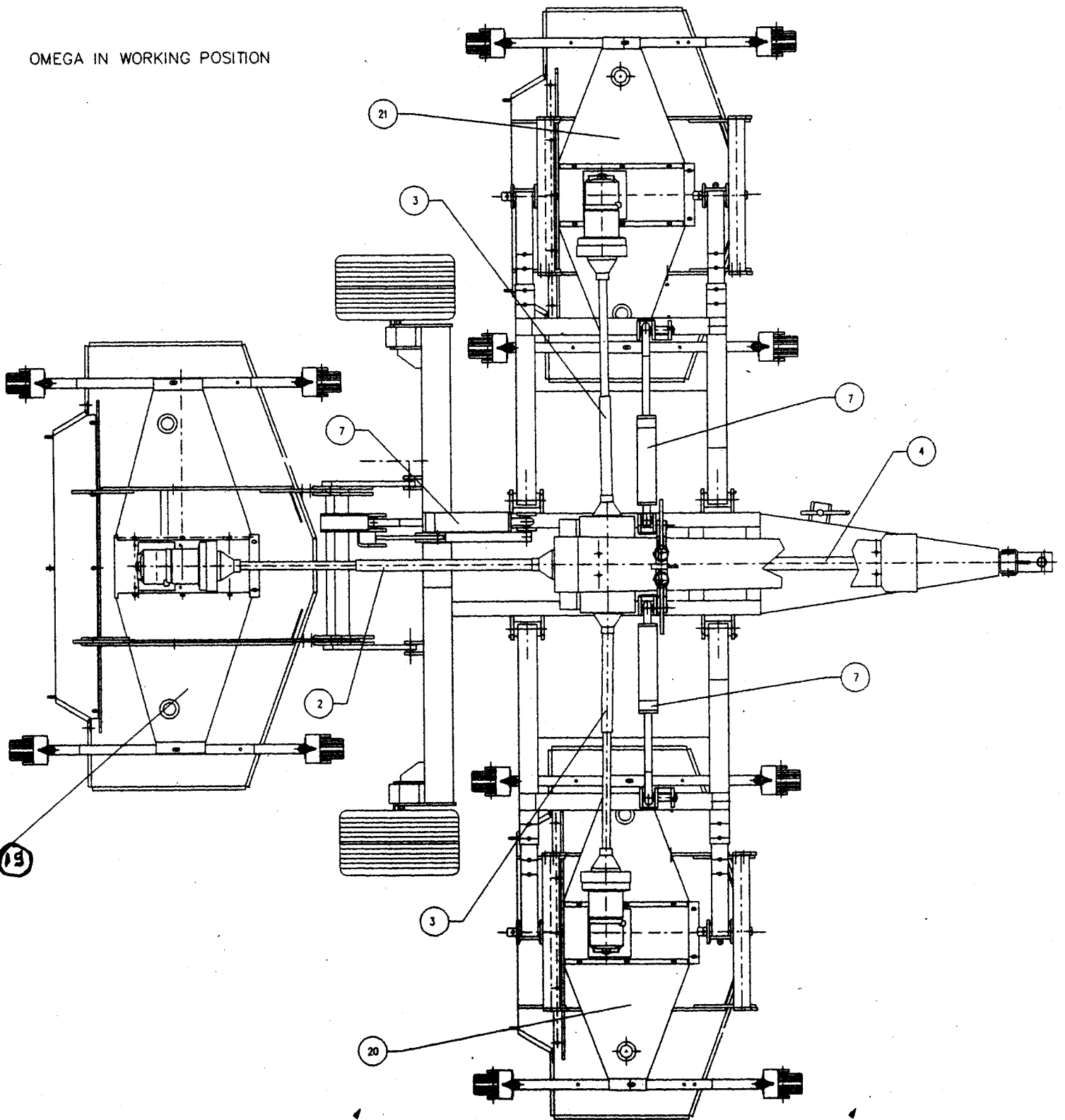



Farm & garden equipment manufacturer

DelMorino

Del Morino srl , v. Caroni di Sotto 19,
I-52033 Caprese Michelangelo AR Italy
Ph: +39-575-791059 Fax: +39-575-791210
E.mail: 100710.3101@compuserve.com
http://www.Italia.com/Delmorino
New E.Mail: delmorin@vinf.ats.it

SPARE PARTS LIST – MOWER TYPE XRM0 FOR OMEGA				
REF.	DESCRIPTION	CODE #	XRM0 235	
1	FRAME	XRM151VD	1	
1**	FRAME NWR	XRM181VD		
2	WHEEL BRACKET FOR RUBBER WHEEL	SRM061VD	2	
2*	WHEEL BRACKET FOR TIRE WHEEL	XRM053VD	2	
2**	WHEEL BRACKET FOR RUBBER WHEEL NWR	PRM065VD	2	
3	COMPLETE RUBBER WHEEL GROUP	SRM071D	4	
3*	COMPLETE TIRE WHEEL GROUP	SRM078D	4	
4	COMPLETE ROTATION GROUP	SRM051D	5	
5	GEAR BOX SUPPORT	SRM070VD	1	
6	BELT COVER CARTER L	XRM154VD	1	
7	BELT COVER CARTER R	XRM153VD	1	
8	DISCHARGE CARTER	XRM052VD	1	
9	BLADE	SRM201D	5	
10	DRIVE PULLEY P250/2B	SRM193D	1	
11	SIDE PULLEY P140/1B	SRM196D	4	
12	CENTRAL PULLEY P140/2B	SRM197D	1	
17	GEAR BOX SLIDE	SRM064VD	1	
18	SAFETY CHAIN AXIS	XRM159D	1	
18**	SAFETY CHAIN AXIS NWR	XRM182D	1	
19	BELT B120	42800004	2	
20	WASHER D24 UNI 6592	40300015	1	
21	CROWN NUT M24 UNI 5594	40200021	1	
22	SPLIT PIN 4.5X50 UNI1337	42700002	1	
23	SCREW M8X16 UNI 5739	40100042	4	
24	SCREW M10X25 UNI 5739	40100043	12	
25	SCREW M10X30 UNI 5739	40100012	23	
26	SCREW M10X80 UNI 5739	40100044	1	
27	SCREW M10X80 UNI 5737	40100045	6	
30	SCREW M16X40 UNI 5933	40100047	4	
31	WASHER D8 UNI 6592	40300002	14	
32	WASHER D10 UNI 6592	40300003	60	
33	WASHER D12 UNI 6592	40300004	8	
34	NUT M10 UNI 5588	40200005	1	
36	NUT CONELOCK M8 DIN 980	40200002	6	
37	NUT CONELOCK M10 DIN 980	40200003	26	
38	NUT CONELOCK M12 DIN 980	40200006	4	
39	NUT CONELOCK M16 DIN 980	40200008	4	
41	COWLING	41900004	1	
42	GEAR BOX COMER 141.002.00	42000006	1	
43	GENOVESE CHAIN WIRE 7.4 –3 LINK	40900003	44	
43**	GENOVESE CHAIN WIRE 7.4- 2 LINK	40900014	43	
44	CHAIN SPACER	DMK191D	42	
45	SPRING PIN D3	41400001	1	
46	RUBBER WHEEL SUPPORT	SRM053VD	4	

SPARE PARTS LIST – MOWER TYPE XRMO FOR OMEGA					
REF.	DESCRIPTION	CODE #	XRMO 235		
46*	TIRE WHEEL SUPPORT	SRM079VD	4		
47	SPACER 2 MM	SRM203ZD	14		
48	SPACER 6 MM	SRM204ZD	4		
49	SPACER 13 MM	SRM205ZD	12		
50	SPACER 25 MM	SRM206ZD	4		
51	SPACER 32 MM	SRM207ZD	12		
52	SCREW M12X110 UNI 5737	40100048	4		
52*	SCREW M12X150 UNI 5737	40100049	4		
53	PIN D6	41300002	4		
54	RUBBER WHEEL DIAMETER 210X80	42900001	4		
54*	TIRE WHEEL DIAMETER 330X125	42900002	4		
55	RUBBER WHEEL BUSH	SRM232D	4		
55*	TIRE WHEEL BUSH	SRM234D	4		
56	HUB	SRM052VD	5		
57	SHAFT	SRM190D	5		
58	SPACER	SRM192D	5		
59	BEARING PROTECTION	SRM191SZ	5		
60	BEARING 6205 Z	41000010	14		
61	TONGUE UNI 6604-A 8X7X35	40500001	5		
62	SELF LOCKING NUT M18 DIN 982 FINE PITCH	40200029	5		
63	SELF LOCKING NUT M25X1.5	40700003	5		
64	GREASER UNI 7663-A-M6X1	40600001	6		
65	ROLL BRACKET	OM065VD	1		
66	ROLL	OM204D	1		
67	ROLL BUSH	OM206D	1		
68	SCREW M12X250 UNI 5737	40100050	1		
69	FREE PULLEY	XRm157D	2		
70**	SAFETY DEVICE NWR	PRM186ZD	40		
71					
72	SEEGER D25 UNI 7435	40400007	2		
73	WASHER D 10X30	40300013	6		
74	WASHER D 10X40	40300028	6		

* : TIRE WHEEL – IN ALTERNATIVE WITH THE SAME POSITION WITHOUT *

** : ONLY FOR DISCHARGE NOT WIND ROW



OUTSTANDING FINISHING MOWER XRMO 235 type

Part list

Variation : centralized lubrication ⇒ CL

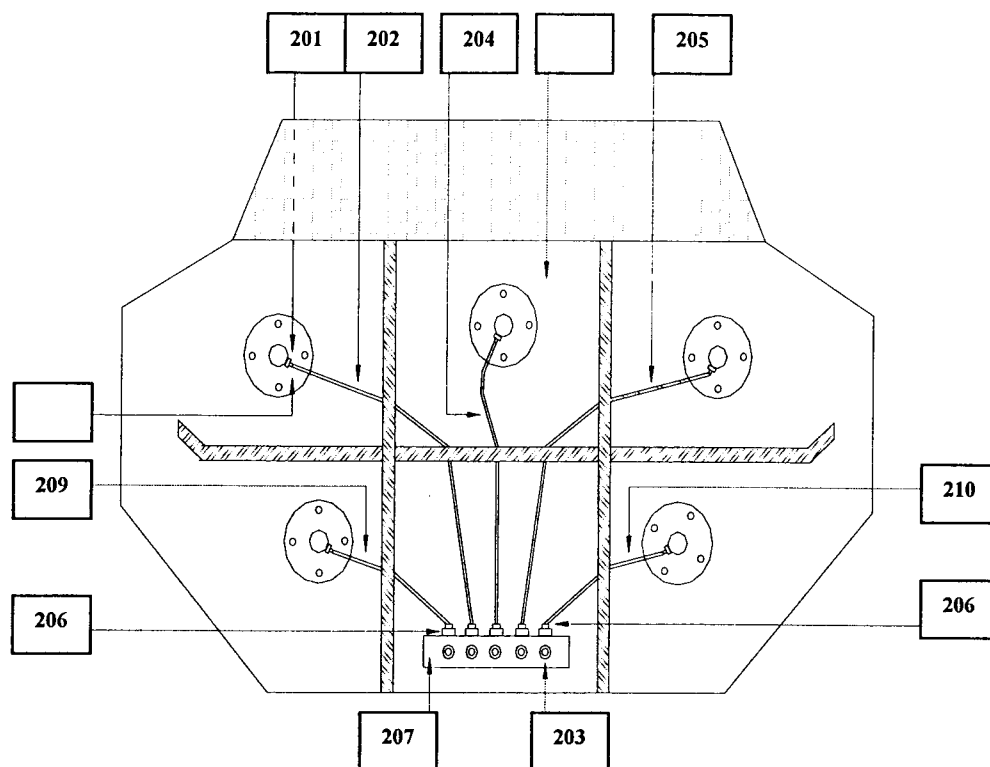

PART LIST			
REF.	DESCRIPTION	CODE #	Q.TY
203	EXTENSIONS CONNECTORS	43000003	5
202	PLASTIC TUBE	43000011	1
204	PLASTIC TUBE	43000007	1
205	PLASTIC TUBE	43000012	1
209	PLASTIC TUBE	43000009	1
210	PLASTIC TUBE	43000010	1
201	CONNECTORS M	43000001	5
206	CONNECTORS F	43000002	5
207	SUPPORT	XRM179VD	1



Farm & garden equipment manufacturer

DelMorino

Del Morino srl , v.Caroni di Sotto 19,
I-52033 Caprese Michelangelo AR Italy
Ph: +39-575-791059 Fax: +39-575-791210
E.mail: 100710.3101@compuserve.com
<http://www.italia.com/Delmorino>
New E.Mail: delmorin@vinf.ats.it

SPARE PARTS LIST – OMEGA FRAME						
REF.	DESCRIPTION	CODE #	FRAME			
1	FRONT CARDAN SHAFT STANDARD	OM501	1			
1**	FRONT CARDAN SHAFT SLIP CLUTCH	OM519	1			
1**	FRONT CARDAN SHAFT FREE WHEEL	OM520	1			
2	REAR CARDAN SHAFT	OM502	1			
3	SIDE CARDAN SHAFT	OM503	2			
4	TRANSMISSION SHAFT	OM504	1			
5	BEARING	OM505	1			
6	GEAR BOX	OM506	1			
7	HIDRAULIC PISTON	OM507	3			
8	REAR SAFETY DEVICE	OM508	1			
9	SIDE SAFETY DEVICE	OM509	1			
10	SIDE LIMIT SWITCH DEVICE	OM510	2			
11	REAR TIE-ROD	OM511	2			
12	HIDRAULIC DISTRIBUTOR	OM512	1			
13	SIDE HIDRAULIC PIPE	OM513	2			
14	REAR HIDRAULIC PIPE	OM514	1			
15	FRONT HIDRAULIC PIPE	OM515	1			
16	LIFTING JACK	OM516	1			
17	REAR WHEEL COMPLETE WITH HUB	OM517	2			
18	COMPLETE PINS KIT	OM518	1			
19*	REAR MOWER		1			
20*	RIGHT SIDE MOWER		1			
21*	LEFT SIDE MOWER		1			

** : IN ALTERNATIVE WITH THE SAME POSITION WITHOUT *

* : SEE SUGGESTER SPARE PARTS LIST FOR PRMO 120-150-180 AND XRM 235



Farm & garden equipment manufacturer

DelMorino

Del Morino srl , v.Caroni di Sotto 19,
I-52033 Caprese Michelangelo AR Italy
Ph: +39-575-791059 Fax: +39-575-791210
E.mail: 100710.3101@compuserve.com
<http://www.Italia.com/Delmorino>
New E.Mail: delmorin@vinf.ats.it

SPARE PARTS LIST – FINISHING MOWER PRMO TYPE

NEW REF.	DESCRIPTION	NEW CODE	OLD CODE			
1	FRAME – 120	PRM051VD	50801			
1**	FRAME – NWR	PRM060VD	-			
1	FRAME – 150	PRM052VD	50802			
1**	FRAME – NWR	PRM061VD	-			
1	FRAME – 180	PRM053VD	50803			
1**	FRAME – NWR	PRM062VD	-			
2	WHEEL BRACKET FOR RUBBER WHEEL – 120	SRM060VD	10026			
2	WHEEL BRACKET FOR RUBBER WHEEL – 150	SRM061VD	10056			
2	WHEEL BRACKET FOR RUBBER WHEEL – 180	SRM062VD	10086			
2*	WHEEL BRACKET FOR TIRE WHEEL	PRM057VD	-			
2*	WHEEL BRACKET FOR TIRE WHEEL	PRM058VD	-			
2*	WHEEL BRACKET FOR TIRE WHEEL	PRM059VD	-			
2*	WHEEL BRACKET FOR RUBBER WHEEL –NWR	PRM063VD	-			
2*	WHEEL BRACKET FOR RUBBER WHEEL – NWR	PRM065VD	-			
3	COMPLETE RUBBER WHEEL GROUP	PRMRG	-			
3*	COMPLETE TIRE WHEEL GROUP	PRMRP	-			
4	COMPLETE ROTATION GROUP	SRM051D	50059			
5	GEAR BOX SUPPORT – 120	SRM068VD	10023			
5	GEAR BOX SUPPORT – 150	SRM069VD	10053			
5	GEAR BOX SUPPORT – 180	SRM070VD	10083			
6	BELT COVER CARTER LEFT – 120	SRM157VD	50123			
6	BELT COVER CARTER LEFT – 150	SRM160VD	50124			
6	BELT COVER CARTER LEFT – 180	SRM162VD	50125			
7	BELT COVER CARTER RIGHT – 120	SRM158VD	10024			
7	BELT COVER CARTER RIGHT – 150	SRM159VD	10054			
7	BELT COVER CARTER RIGHT – 180	SRM161VD	10084			
8	DISCHARGE CARTER	PRM054VD	-			
8	DISCHARGE CARTER	PRM055VD	-			
8	DISCHARGE CARTER	PRM056VD	-			
9	BLADE – 120	SRM200D	50064			
9	BLADE – 150	SRM201D	50065			
9	BLADE – 180	SRM202D	50066			
10	DRIVE PULLEY P250/2B	SRM193D	50048			
11	SIDE PULLEY P120/1B	SRM194D	50049			
11	SIDE PULLEY P140/1B	SRM196D	50050			
11	SIDE PULLEY P170/1B	SRM198D	50051			
12	CENTRAL PULLEY P120/2B	SRM195D	50052			
12	CENTRAL PULLEY P140/2B	SRM197D	50053			
12	CENTRAL PULLEY P170/2B	SRM199D	50054			
17	GEAR BOX SLIDE – 120	SRM063VD	10022			
17	GEAR BOX SLIDE – 150-180	SRM064VD	10052			
18	SAFETY CHAIN AXIS – 120	PRM157D	50450			
18**	SAFETY CHAIN AXIS – NWR – 120	PRM183D	-			
18	SAFETY CHAIN AXIS – 150	PRM158D	50451			

SPARE PARTS LIST – FINISHING MOWER PRMO TYPE

NEW REF.	DESCRIPTION	NEW CODE	OLD CODE			
18**	SAFETY CHAIN AXIS – NWR – 150	PRM184D	-			
18	SAFETY CHAIN AXIS – 180	PRM159D	50452			
18**	SAFETY CHAIN AXIS – NWR – 180	PRM185D	-			
19	BELT B57	42800001	50055			
19	BELT B69	42800002	50056			
19	BELT B79	42800003	50057			
20	WASHER D24 UNI 6592	40300015	50035			
21	CROWN NUT M24 UNI 5594	40200021	50026			
22	SPLIT PIN 4.5X50 UNI1337	42700002	50038			
23	SCREW M8X16 UNI 5739	40100042	50014			
24	SCREW M10X25 UNI 5739	40100043	50012			
25	SCREW M10X30 UNI 5739	40100012	50017			
26	SCREW M10X70 UNI 5739	40100062	50016			
26	SCREW M10X80 UNI 5739	40100044	50015			
27	SCREW M10X80 UNI 5737	40100045	50013			
30	SCREW M16X40 UNI 5933	40100047	50011			
31	WASHER D8 UNI 6592	40300002	50004			
32	WASHER D10 UNI 6592	40300003	50002			
33	WASHER D12 UNI 6592	40300004	50001			
34	NUT M10 UNI 5588	40200005	50022			
36	NUT CONELOCK M8 DIN 980	40200002	50025			
37	NUT CONELOCK M10 DIN 980	40200003	50022			
38	NUT CONELOCK M12 DIN 980	40200006	50020			
39	NUT CONELOCK M16 DIN 980	40200008	50021			
40	NUT M22 UNI 5588 FINE PITCH	40200025	50021			
41	COWLING	41900004	50034			
42	GEAR BOX COMER 141.003.00-540 R.P.M. LEFT	42000010	50058			
42***	GEAR BOX COMER 141.002.00-540 R.P.M. RIGHT	42000006	-			
43	GENOVESE CHAIN WIRE 7.4 –3 LINK	40900003	50074-75-76			
43**	GENOVESE CHAIN WIRE 7.4 –2 LINK	40900014	-			
44	CHAIN SPACER	DMK191D	50068-69-70			
45	SPRING PIN D3	41400001				
46	RUBBER WHEEL SUPPORT	SRM053VD	50039			
46*	TIRE WHEEL SUPPORT	SRM079VD	-			
47	SPACER 2 MM	SRM203ZD	50040			
48	SPACER 6 MM	SRM204ZD	50041			
49	SPACER 13 MM	SRM205ZD	50042			
50	SPACER 26 MM	SRM206ZD	50043			
51	SPACER 33 MM	SRM207ZD	50044			
52	SCREW M12X110 UNI 5737	40100046	50010			
52*	SCREW M12X150 UNI 5737	40100049	-			
53	PIN D6	41300002	50031			
54	RUBBER WHEEL DIAMETER 210X80	42900001	50045			
54*	TIRE WHEEL DIAMETER 330X125	42900002	-			
55	RUBBER WHEEL BUSH	SRM232D	50047			
55*	TIRE WHEEL BUSH	SRM234D	-			
56	HUB	SRM052VD	50059			

SPARE PARTS LIST – FINISHING MOWER PRMO TYPE							
NEW REF.		DESCRIPTION	NEW CODE	OLD CODE			
57		SHAFT	SRM190D	50063			
58		SPACER	SRM192D	50060			
59		BEARING PROTECTION	SRM191ZD	50062			
60		BEARING 6205 Z	41000010	50061			
61		TONGUE UNI 6604-A 8x7x35	40500001	50035			
62		SELF LOCKING NUT M18 DIN 982 FINE PITCH	40200029	50027			
63		SELF LOCKING NUT M25X1.5	40700003	50036			
64		GREASER UNI 7663 – A-M6x1	40600001	50029			
71		WASHER D 10x30	40300013				
72		WASHER D 10x40	40300028	50006			

* : TIRE WHEEL – IN ALTERNATIVE WITH THE SAME POSITION WITHOUT *

** : ONLY FOR DISCHARGE NOT WIND ROW

*** : IN ALTERNATIVE WITH THE SAME POSITION WITHOUT ***



Farm & garden equipment manufacturer

DelMorino

Del Morino srl , v.Caroni di Sotto 19,
I-52033 Caprese Michelangelo AR Italy
Ph: +39-575-791059 Fax: +39-575-791210
E.mail: 100710.3101@compuserve.com
http://www.Italia.com/Delmorino
New E.Mail: delmorin@vinf.ats.it

SPARE PARTS LIST – FINISHING MOWER XRMO TYPE					
REF.		DESCRIPTION	NEW CODE	OLD CODE	
1		FRAME	XRM051VD	50103	
1**		FRAME NWR	XRM054VD	-	
2		WHEEL BRACKET FOR RUBBER WHEEL	SRM061VD	10056	
2*		WHEEL BRACKET FOR TIRE WHEEL	XRM053VD	-	
2**		WHEEL BRACKET FOR RUBBER WHEEL NWR	PRM065VD	-	
3		COMPLETE RUBBER WHEEL GROUP	SRM071D	-	
3*		COMPLETE TIRE WHEEL GROUP	SRM078D	-	
4		COMPLETE ROTATION GROUP	SRM051D	50059	
5		GEAR BOX SUPPORT	SRM070VD	50316	
6		BELTC COVER CARTER LEFT	XRM154VD	50306	
7		BELT COVER CARTER RIGHT	XRM153VD	50305	
8		DISCHARGE CARTER	XRM052VD	50096	
9		BLADE	SRM201D	50065	
10		DRIVE PULLEY P250/2B	SRM193D	50048	
11		SIDE PULLEY P140/1B	SRM196D	50050	
12		CENTRAL PULLEY P140/2B	SRM197D	50053	
17		GEAR BOX SLIDE	SRM064VD	10052	
18		SAFETY CHAIN AXIS	XRM159D	50083	
18**		SAFETY CHAIN AXIS NWR	XRM182D	-	
19		BELT B120	42800004	50095	
20		WASHER D24 UNI 6592	40300015	50035	
21		CROWN NUT M24 UNI 5594	40200021	50026	
22		SPLIT PIN 4.5X50 UNI1337	42700002	50038	
23		SCREW M8X16 UNI 5739	40100042	50014	
24		SCREW M10X25 UNI 5739	40100043	50012	
25		SCREW M10X30 UNI 5739	40100012	50017	
26		SCREW M10X80 UNI 5739	40100044	50015	
27		SCREW M10X80 UNI 5737	40100045	50013	
30		SCREW M16X40 UNI 5933	40100047	50011	
31		WASHER D8 UNI 6592	40300002	50004	
32		WASHER D10 UNI 6592	40300003	50002	
33		WASHER D12 UNI 6592	40300004	50001	
34		NUT M10 UNI 5588	40200005	50022	
36		NUT CONELOCK M8 DIN 980	40200002	50025	
37		NUT CONELOCK M10 DIN 980	40200003	50022	
38		NUT CONELOCK M12 DIN 980	40200006	50020	
39		NUT CONELOCK M16 DIN 980	40200008	50024	
40		NUT M22 UNI 5588	40200025	50021	
41		COWLING	41900004	50034	
42		GEAR BOX COMER 141.003.00-540 R.P.M. LEFT	42000010	50800	
42***		GEAR BOX COMER 141.002.00-540 R.P.M. RIGHT	42000006	-	
43		GENOVESE CHAIN WIRE 7.4 –3 LINK	40900003	50084	

SPARE PARTS LIST – FINISHING MOWER XRMO TYPE

REF.	DESCRIPTION	NEW CODE	OLD CODE		
43**	GENOVESE CHAIN WIRE 7.4 –2 LINK	40900014	-		
44	CHAIN SPACER	DMK191D	50085		
45	SPRING PIN D3	41400001	50038		
46	RUBBER WHEEL SUPPORT	SRM053VD	50039		
46*	TIRE WHEEL SUPPORT	SRM079VD	-		
47	SPACER 2 MM	SRM203ZD	50040		
48	SPACER 6 MM	SRM204ZD	50041		
49	SPACER 13 MM	SRM205ZD	50042		
50	SPACER 26 MM	SRM206ZD	50043		
51	SPACER 33 MM	SRM207ZD	50044		
52	SCREW M12X110 UNI 5737	40100048	50010		
52*	SCREW M12X150 UNI 5737	40100049	-		
53	PIN D6	41300002	50031		
54	RUBBER WHEEL DIAMETER 210X80	42900001	50045		
54*	TIRE WHEEL DIAMETER 330X125	42900002	-		
55	RUBBER WHEEL BUSH	SRM232D	50047		
55*	TIRE WHEEL BUSH	SRM234D	-		
56	HUB	SRM052VD	50059*		
57	SHAFT	SRM190D	50063		
58	SPACER	SRM192D	50060		
59	BEARING PROTECTION	SRM191SZ	50062		
60	BEARING 6205 Z	41000010	50061		
61	TONGUE UNI 6604-A 8X7X35	40500001	50035		
62	SELF LOCKING NUT M18 DIN 982 FINE PITCH	40200029	50027		
63	SELF LOCKING NUT M25X1.5	40700003	50036		
64	GREASER UNI 7663-A-M6X1	40600001	50029		
65	ROLL BRACKET	OM065VD	50229		
66	ROLL	OM204D	50228		
67	ROLL BUSH	OM206D	-		
68	SCREW M12X250 UNI 5737	40100050	50097		
69	FREE PULLEY	XRM157D	50102		
70**	SAFETY DEVICE NWR	PRM186ZD	-		
72	SEEGER ϕ 25 UNI 7435	40400007	50101		
73	WASHER D 10X30	40300013			
74	WASHER D 10X40	40300028	50006		

* : TIRE WHEEL – IN ALTERNATIVE WITH THE SAME POSITION WITHOUT*

** : ONLY FOR DISCHARGE NOT WIND ROW

*** : IN ALTERNATIVE WITH THE SAME POSITION WITHOUT ***

USE AND MAINTENANCE MANUAL

OMEGA

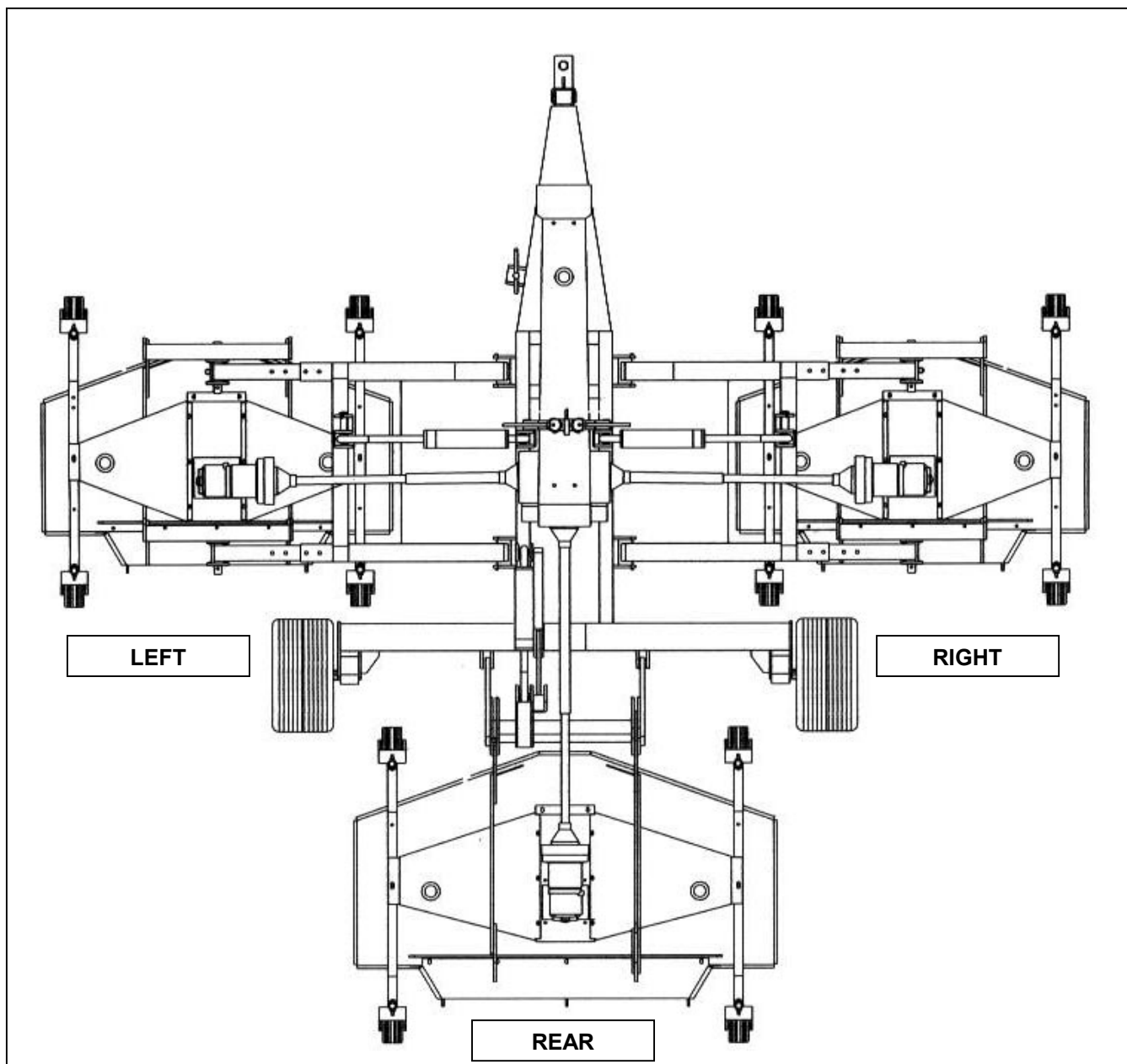

PREFACE

This manual is an integral part of the machine.

It must always accompany the machine and be kept within reach of the operator.

The enclosures mentioned are an integral part of this manual.

The purpose of this manual.

This manual gives information for the correct and safe use of the machine.

The owner must read this manual carefully before work with the machine.

Responsibility of the owner

The owner is responsible for accidents or damages caused to people or things due to negligence in following the instructions in this manual.

Assistance in using this manual

Explanations: contact the dealer.

Request for additional copies of the manual: in case of loss or wear and tear, or in case one wants the manual in a different language, the customer should ask the dealer or manufacturer.

Pay attention to the warning signals



<Danger>: indicates a situation that is potentially dangerous which, if not avoided, will cause death or serious damage.



<Warning>: indicates a situation that is potentially dangerous which, if not avoided, will cause death or serious damage.



<Caution>: indicates a situation that is potentially dangerous which, if not avoided, can cause minor to moderate damage, or it indicates to be careful about an unsafe procedure.

<Important> : indicates instructions that must be followed precisely in order to avoid damage to the product, process

or environment.

<Note>: indicates supplementary information.

DESCRIPTION

FUNCTION OF USE

The machine gives grass a professional cut. The grass is first raised, then cut with precision and discharged in the rear side along the width of discharge.

It perfects any preliminary cut.

The machine is formed by 3 cutting components; each one moves in the soil with 4 pivotal wheels; each component is free in the movements to adjust itself to the soil.

Each component takes the motion through homokinetic joints by a gear box with 4 way actioned by the PTO of the tractor.

The 3 components follow perfectly the line of the soil making a uniform cutting action of high quality.

PERFORMANCES

The frame, where the cutting components are connected, permits to raise the 3 mowers for the transport, through a hydraulic integrated system.

The pivotal wheels of the components, permit the best control both on forward gear and reverse gear; the wheels have dimensions so as not to damage the turf.

The height of the cut is adjustable from 1 to 4 inches through distance washers that can be inserted in the vertical pivotal axles.

The components always has their 4 wheels on the ground.

The small chains situated at the exit of the rear discharges, are a protection for eventual throws of objects that could be hidden on the turf. Also, they disperse evenly the cut grass.

The cutting components of the machine, have the "central" lubrication of the blade-supports; in this way, the operator can see and approach immediately the lubrication points.

PERFORMANCES LIMITS

- Maximum forwarding speed : 5 m.p.h.
- Speeds greater than the maximum can compromise the condition of the machine, the quality of the work and the safety of the operator.
- Maximum power applicable to the gear box: 41 Kw \pm 5% with 540 r.p.m.
- Superior power to which is indicated can damage irreparably the transmission gear box; especially during heavy works.

STANDARD EQUIPMENT

- Clutch cardan shaft.
- Mowers with rubber wheels.
- Centralized lubrication.

VARIANTS & OPTIONS

- Mowers with rubber wheels ϕ 310.
- Mowers with pneumatic wheels ϕ 330.
- Wide angle clutch cardan shaft.

SAFETY DEVICES

The machine is equipped with a lock device with a manual unhooking that keep the casual descent of the 3 cutting components during the transport and maintenance operations.

TECHNICAL SPECIFICATIONS

DRAW-HOOK OF THE TRACTOR

The diameter of the hitch pin must not be less than 30 mm., the pin must be produced in C 40 steel or similar and must be equipped to the extremities of a hole to apply the safety spring pin.

CHARACTERISTICS PER MODEL

Model	Type	Mowers		Cutting width		Cutting height		Blade tip speed		Blade speed		Blade number	
		Side	Rear	Ft	mm	Inch	mm	F/M	m/s	R.p.m.	N°		
OMEGA	11	2x48"	1x48"	132"	3300	1÷4	25÷100	13773	4225	3250	(3x3) =9		
	12	2x48"	1x60"	144"	3600	1÷4	25÷100				(3x3) =9		
	14	2x60"	1x60"	168"	4200	1÷4	25÷100	13718	4208	2630	(3x3) =9		
	15	2x60"	1x72"	180"	4500	1÷4	25÷100				(3x3) =9		
	17	2x72"	1x72"	204"	5100	1÷4	25÷100	14083	4320	2250	(3x3) =9		
	19	2x72"	1x93"	222"	5650	1÷4	25÷100				(3x2)+5 =11		
21	2x85"	+1x93"	2502	6350	1÷4	25÷100	16104	80	2125	(3x2)+5 =11			
Model	Type	Mowers		Power consumption Kw R.p.m.		Storage Width Lenght				Work speed		Weight	
		Side	Frontal	Central	Secondary	Inch	m	Inch	M	km/h	Mi/h	Lbs	Kg
OMEGA	11	2x48"	1x48"	41+540	16	94"	2,40	141"	3,60	15	9,5	2222	1010
	12	2x48"	1x60"			94"	2,40	141"	3,60	15	9,5	2244	1020
	14	2x60"	1x60"	41+540	16	94"	2,40	147"	3,75	15	9,5	2332	1060
	15	2x60"	1x72"			94"	2,40	147"	3,75	15	9,5	2376	1080
	17	2x72"	1x72"	41+540	16	96"	2,45	153"	3,90	15	9,5	2508	1140
	19	2x72"	1x93"			96"	2,45	153"	3,90	15	9,5	2684	1220
21	2x85"	+1x93"	41+540	16	98"	2,50	153"	3,90	15	9,5	2860	1300	

SAFETY INFORMATION

GENERAL REGULATIONS

- ❑ Only work in daylight.
- ❑ The machine must not be used near people, especially children or animals.
- ❑ Wear long pants and heavy shoes.
- ❑ The protections are integral part of the machine: always work with the protections.
- ❑ Make sure that the 4 wheels of all components be adjusted to the same cutting height.
- ❑ Pay attention to the soil: make sure that are not stones, sticks, iron wires, etc...
- ❑ Pay attention using the machine on slopes: proceed to the maximum slope and never work in slanting direction.
- ❑ Before leaving the driver's seat, turn off the engine and disengage the transmission engine-shaft.
- ❑ Check immediately the machine if it touches foreign objects.
- ❑ Check immediately the machine if there are unusual strong vibrations.
- ❑ Change quickly defective parts.

SAFETY RESTRICTIONS

Children and people who are not familiar with these instructions must not be permitted to use the machine. Local regulations can restrict the use of the machine in accordance to the age.

SAFETY SIGNS ON THE MACHINE

In this section, the safety signs on the machine are reproduced and explained.



1. Read the operator manual.
2. Disconnect the tractor key before maintenance and repair operations.
3. Stay at safety distance from blades when machine is moving.
1. Danger of flying objects. Stay at safety distance.
4. Stay at safety distance from blades when machine is moving.
5. Stay at safety distance from blades when machine is moving.

The safety signs on the machine must always be legible.

In case of damage, the labels of the signs must be substituted.

In the case of the substitution of machine parts that have safety signs, the signs must be replaced.

Supplying of new safety labels and the application procedure

Contact your dealer to receive new safety labels with instructions for application.

ASSEMBLING INSTRUCTIONS

PARTS LIST		
POS.	DESCRIPTION	Q.TY'
1	MAIN FRAME	1
2	REAR HUB	2
3	REAR WHEEL	2
4	LIFTING JACK	1
5	RIGHT SIDE CONNECTION FRAME	1
6	LEFT SIDE CONNECTION FRAME	1
7	REAR CUTTING COMPONENT	1
8	RIGHT SIDE CUTTING COMPONENT	1
9	LEFT SIDE CUTTING COMPONENT	1
10	CROSS BAR WHEEL CASE	6
11	MOWER WHEEL GROUP	12
12		
13	CASING	3
14	SIDE CONNECTION BRACKET	4
15	SIDE CONNECTION BEAM	4
16	REAR CONNECTION FRAME	1
17	REAR END STROKE ROD	2
18	HYDRAULIC RAM	3
19	SIDE SAFETY DEVICE	1
20	REAR SAFETY DEVICE	1
21	SIDE END STROKE ROD	2
22	SIDE HOMOKINETIC CARDAN JOINT	2
23	REAR HOMOKINETIC CARDAN JOINT	1
24	POWER CARDAN JOINT	1
25	POWER DRIVING GROUP CARTER	1
26	DRAW-HOOK	1
27	SIDE HYDRAULIC PIPE	2
28	REAR HYDRAULIC PIPE	1

- ❑ OMEGA is delivered disassembled in the parts listed in the **PARTS LIST**, for transport necessities.
- ❑ All bolts, pins, safety clips pins, the click pins, the distance washers, are supplied already inserted in their seats.
- ❑ For a perfect assembling operation of the mower, must refer to the assembling scheme and to the assembling instructions showed in this manual.
- ❑ To avoid problems, follow scrupulously the succession of the steps indicated in the instructions utilizing only the bolts and accessories supplied with the machine.
- ❑ The assembling of the machine doesn't request any special equipment, during assembling steps, follow the normal anti-labour accident regulations.

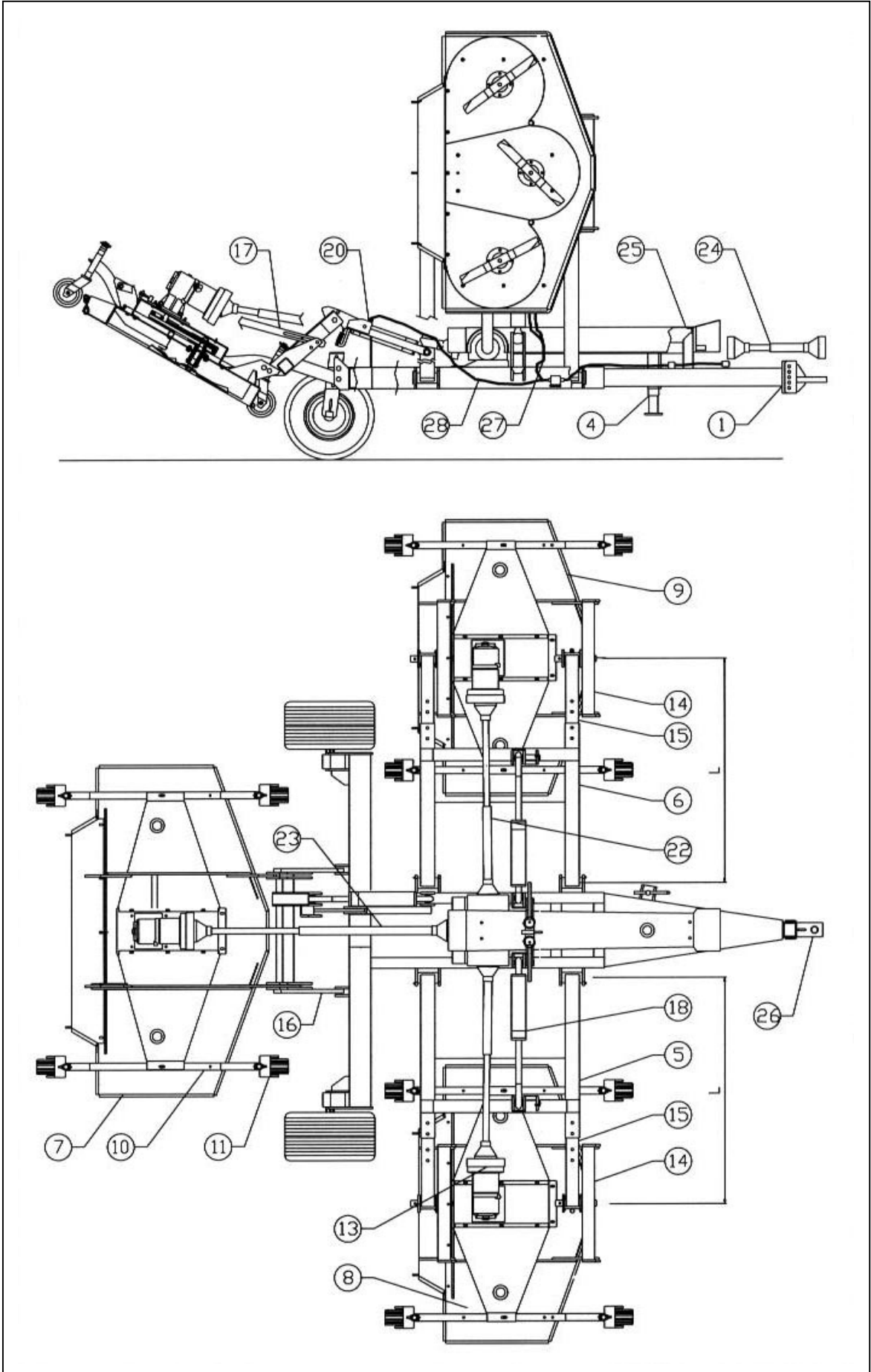



TABELLA "B"

MODELLO	TAGLIERBA 8+9	TAGLIERBA 7	L mm
OMEGA 11	PRM 120	PRM 120	965
OMEGA 12	PRM 120	PRM 150	965
OMEGA 14	PRM 150	PRM 150	1115
OMEGA 15	PRM 150	PRM 180	1265
OMEGA 17	PRM 180	PRM 180	1415
OMEGA 19	PRM 180	XRM 235	1690

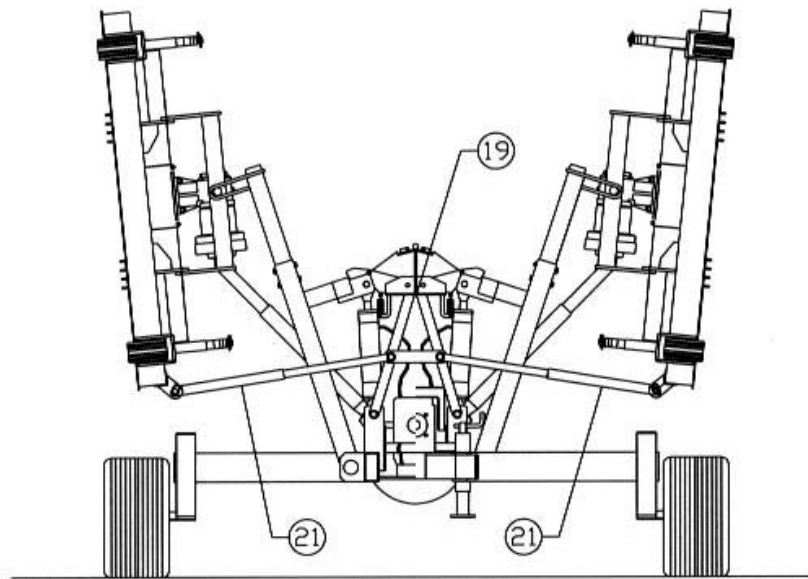

TABELLA "A"

GRUPPO RUOTA 11	REGOLAZIONE MOZZO 2
GOMMA	POSIZIONE 1
PNEUMATICA	POSIZIONE 2

1. MAIN FRAME "1" ASSEMBLING

- a) Insert the **REAR HUB "2"** in the fitting fork found in the rear right side from the **MAIN FRAME "1"**, adjust it the height on **POSITION 1** if the cutting components are equipped with rubber wheels, or in **POSITION 2** if the cutting components are equipped with pneumatic tires (see **TABLE "A"** on reference scheme), insert the screws and lock them with nuts.
- b) Insert the **REAR WHEEL "3"** in the hub, fix it with the special nut.
- c) Repeat steps "a" and "b" on the rear left side of the **MAIN FRAME**.
- d) Insert the **LIFTING JACK "4"** in the seat found in the front of the **MAIN FRAME**, insert the screw and lock it with the nut.
- e) Insert the **RIGHT SIDE CONNECTION FRAME "5"** in the special forks found on the right side of the **MAIN FRAME** orienting it with the hitch fork hydraulic ram oriented to the top, insert the pins and lock them with the nuts.
- f) Insert the hitch welded at the bottom of the **HYDRAULIC RAM "18"** in the special fork found on the right side of the **MAIN FRAME**. Insert the pin but not screw the fixing nut.
- g) Repeat steps "e" and "f" on the left side of the **MAIN FRAME** utilizing the **LEFT SIDE CONNECTION FRAME "6"**.
- h) Insert the **FRONT SIDE SAFETY DEVICE "19"** on the fixing pins of the hydraulic rams orienting them with the guides side end stroke rod oriented to the front of the frame, lock it utilizing the nuts described in the step "f".
- i) Insert the hitch screwed to the hydraulic ram stem in the special fork found on the right connection frame, insert the pin and lock it with the safety clips. Extend the ram until carry the frame in horizontal position.
- j) Repeat step "i" on the left side of the **MAIN FRAME**.
- k) Insert the **REAR CONNECTION FRAME "16"** in his special forks found in the rear side of the main frame orienting it with the hitch fork hydraulic ram oriented to the up, insert the pins and lock them with the nuts.
- l) Insert the hitch welded on the bottom of the **HYDRAULIC RAM "18"** in his special fork found on the left rear side of the main frame. Insert the pin but don't lock the fixing nut.
- m) Insert the **REAR SAFETY DEVICE "20"** on the fixing pin of the hydraulic ram orienting it with the fixing bracket oriented to the low, lock it utilizing the nut described in the step "l" and the locking screw of the bracket.
- n) Insert the hitch locked to the hydraulic ram stem in his special fork found on the rear connection frame, insert the pin and lock it with the safety clips. Extend the ram until carry the frame in horizontal position.
- o) Connect the unhooking cable to the rear safety device through the special spring-clip.
- p) Remove from the connector situated in the right top side of the hydraulic ram the protection cap, lock the terminal connector of the **SIDE HYDRAULIC PIPE "27"** to the ram connector.
- q) Repeat step "p" on the left of the machine.
- r) Remove the protection cap from the connector situated in the up side of the hydraulic ram, lock the terminal connector of the **REAR HYDRAULIC PIPE "28"** to the ram connector.

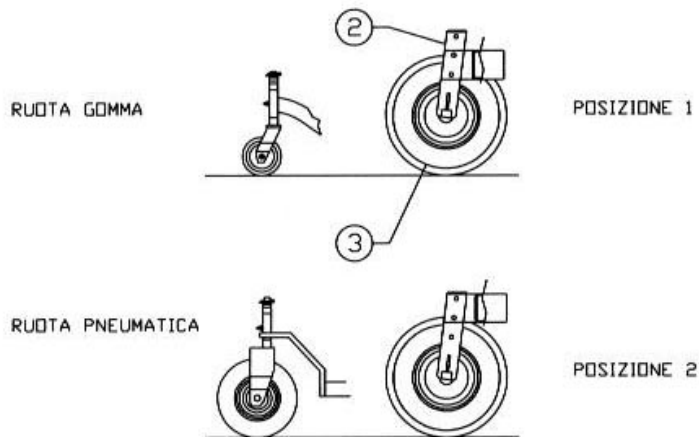
- s) accordance with the height of the tractor draw-hook and to permit to the machine to work the most parallelly to the ground , insert the screws and lock the nuts.

2. MOUNTING RIGHT CUTTING COMPONENT "8"

- a) Insert the **CROSS BAR WHEEL CASE "10"** in the seat found on the right of the **RIGHT CUTTING COMPONENTS "8"**, insert the screws and lock them with the nuts.
- b) Insert in the front and rear hub of the right wheel-support cross bar the **MOWER WHEEL GROUP "11"**, insert the distance washers, the click pin and lock.
- c) Repeat steps "a" and "b" on the left side of the cutting component.
- d) Insert the **SIDE CONNECTION BRACKET "14"** in the seat predisposed in the front side of the cutting component, insert the screws and lock them with the nuts.
- e) Repeat step "d" in the rear side of the cutting component.
- f) Mount the **CASING "13"** in the gear box.

3. MOUNTING LEFT CUTTING COMPONENT "9"

- a) Repeat the operations from "a" to "f" described in the phase "2".

4. MOUNTING REAR CUTTING CUTTING COMPONENT "7"

- a) Repeat steps from "a" to "c" and step "f" described in the phase "2".

5. MOUNTING RIGHT CUTTING COMPONENT ON MAIN FRAME

- a) Insert the **SIDE CONNECTION BEAM "15"** with the seat oriented to the low in the pin of the front connecting bracket, insert the pin and lock with the safety clip.
- b) Repeat step "a" on the rear bracket.
- c) Insert the two connecting beams in their seats of the connecting frame fixed in the right side of the main frame, adjust the inter-axle "L" following the indications on the table "B", insert the screws and lock them with the nuts.
- d) Insert the **SIDE END STROKE ROD "21"** in the right guide of the side safety device. Insert the hitch on the other end of the same rod into the fork found on the left side of the right cutting component. Insert the pin and lock it with the safety clips.

6. MOUNTING LEFT CUTTING COMPONENT ON MAIN FRAME

- a) Repeat steps "a" to "d" described in phase "5".

7. MOUNTING REAR CUTTING COMPONENT ON MAIN FRAME

- a) Insert the hitches found on the front of the rear connecting frame. Insert the screws and lock them with the nuts.
- b) Insert the head holes of the **REAR END STROKE ROD "17"** into the forks found on the rear side of the rear connecting frame. Insert the screws and lock them with nuts.
- c) Insert the free ends of the rear end stroke rod into the forks on the upper side of the rear cutting component. Insert the screws and lock them with nuts.

8. FINAL ASSEMBLING

- a) Insert the end of the **SIDE HOMOKINETIC CARDAN JOINT "22"**, directioning it as in the diagram, in the shaft located on the right side of the gear box mounted on the main frame. Insert the other end of the cardan joint in the shaft of the angular gear box mounted on the right cutting component.
- b) Repeat step "a" on the left side of the machine.
- c) Insert the end of the **REAR HOMOKINETIC CARDAN JOINT "23"**, directioning it as in the diagram, in the shaft located on the rear side of the gear box mounted on the main frame. Insert the other end of the cardan joint in the shaft of the angular gear box mounted on the rear cutting component.
- d) Position the **POWER DRIVING GROUP CARTER "25"** on the main frame. Insert the screws and lock them with nuts.

9. GREASING AND LUBRICATION

In accordance with transportation regulations the machine comes without oil or grease. Therefore it must be greased and lubricated before using.

To do this see the section "**MAINTENANCE INSTRUCTIONS**" points "1-2-3-4" page 16 and 17.

1. BEFORE BEGINNING WORK

- a) Ceck oil level in gear boxes . (see page 17 point "4")
- b) Hook the machine to the tractor.
- c) Connect the hydraulic system of the machine to that of the tractor by means of the quick coupling (fast clutch).
- d) Make sure that the safety stops are hooked and the cutting components raised.
- e) If necessary regulate the cutting height, referring to diagram "A", as follows :
 1. Remove the spring pin from the pivotal axle.
 2. Move the distance washer above or below the hub.
 3. Reposition the spring pin.
 4. Make sure that the same cutting height is set up on each wheel of all cutting components.

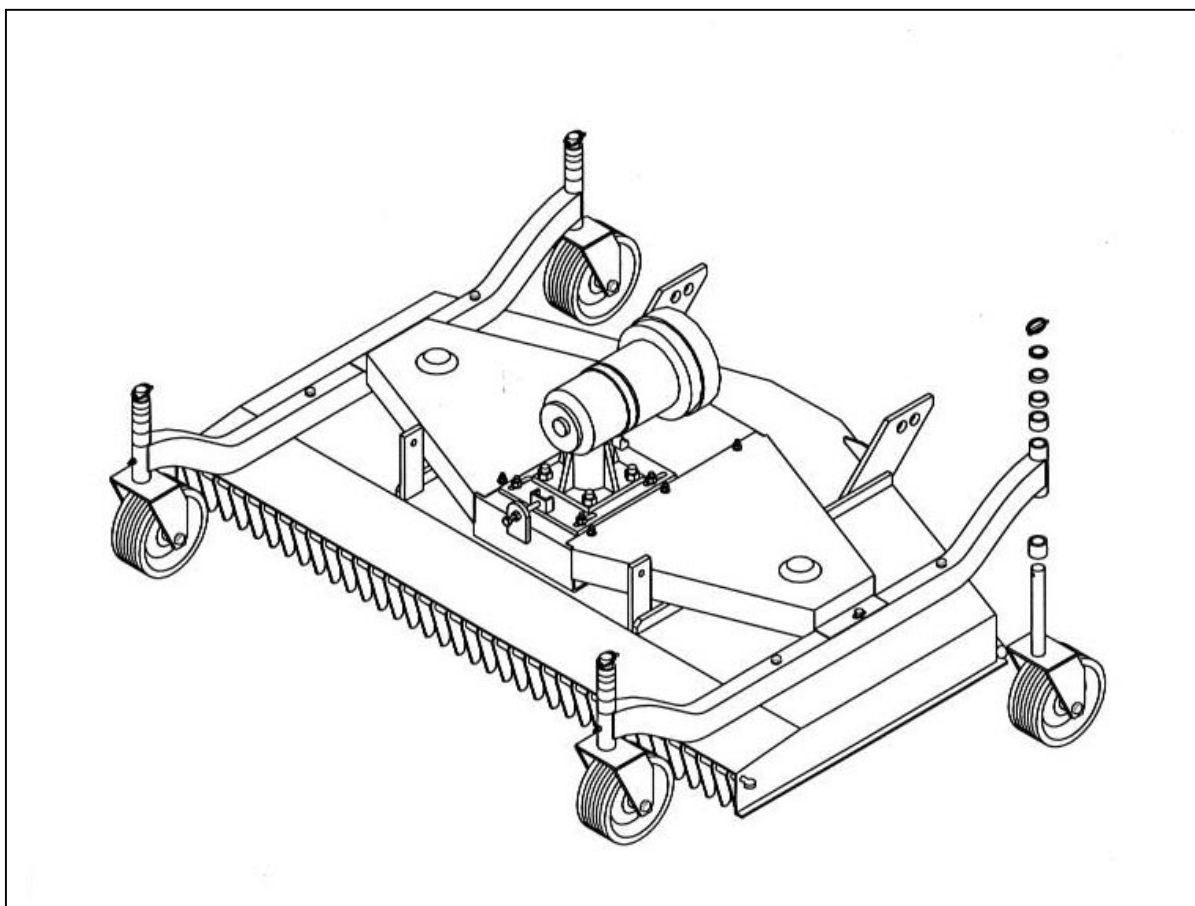

- f) Connect the cardan shaft to machine P.T.O.
- g) Check that the PTO chain is attached to the dragging hook so as to prevent the protection sheath of the PTO from rotating.

2. TO BEGINNING WORK

- a) Keep people, animals and things at least 15 meters from the machine. Start the engine and lower the 3 cutting components as follows:
- b) Pull the cable to free the side safety hooks. Activate the hydraulic switch and wait until the 2 side cutting components are touching the ground.
- c) Pull the cord again to free the rear safety hook. Activate the hydraulic switch and wait until the rear cutting component is touching the ground.
- d) Insert the PTO gradually bring it to 540 r.p.m.
- e) Begin cutting.

3. AT THE END OF WORK

- a) Stop the tractor.
- b) Disconnect the PTO.
- c) Disconnect the cardan joint.
- d) Raise the 3 cutting components.
- e) Make sure that the safety hooks are in the correct position.
- f) Clean the under sides of the cutting components to remove deposits of grass and dirt. Use a wooden spatula so as not damage the paint.
- g) Proceed to a visual check of the blades to make sure if there are damages.

MAINTENANCE INSTRUCTIONS

On diagram "A" the maintenances are indicated with their terms to effect on the machine.
 Not follow the scheduled terms can compromise the functionality of the machine and in this case the warranty is not applicable.

DIAGRAM "A" SCHEDULED MAINTENANCE

	FIRST START	AFTER 10 H.	EACH 30 H.	EACH 500 H.	END SEASON	BEGINNING WORK	END WORK
MACHINE	Greasing		Greasing		Cleaning Greasing		Cleaning
OIL	Put	Check level	Check level	Substitution		Check level	
SCREWS		Locking	Locking				
BLADES			Check Sharpeness Balance				Check Cleaning
BELTS		Check tension	Check tension	Substitution			

1. FRAME GREASING

All the greasing points, both those situated and both centralized, are equipped with greaser HYDRAULIC TYPE MODEL "A" UNI 7663.

To grease use only MULTIFUNCTIONAL GREASE LITHIUM BASED Type NLGI 2.

Refer to the scheme, the greasing points are the points "A".

Greasing operation must be made at the terms scheduled on diagram "A".

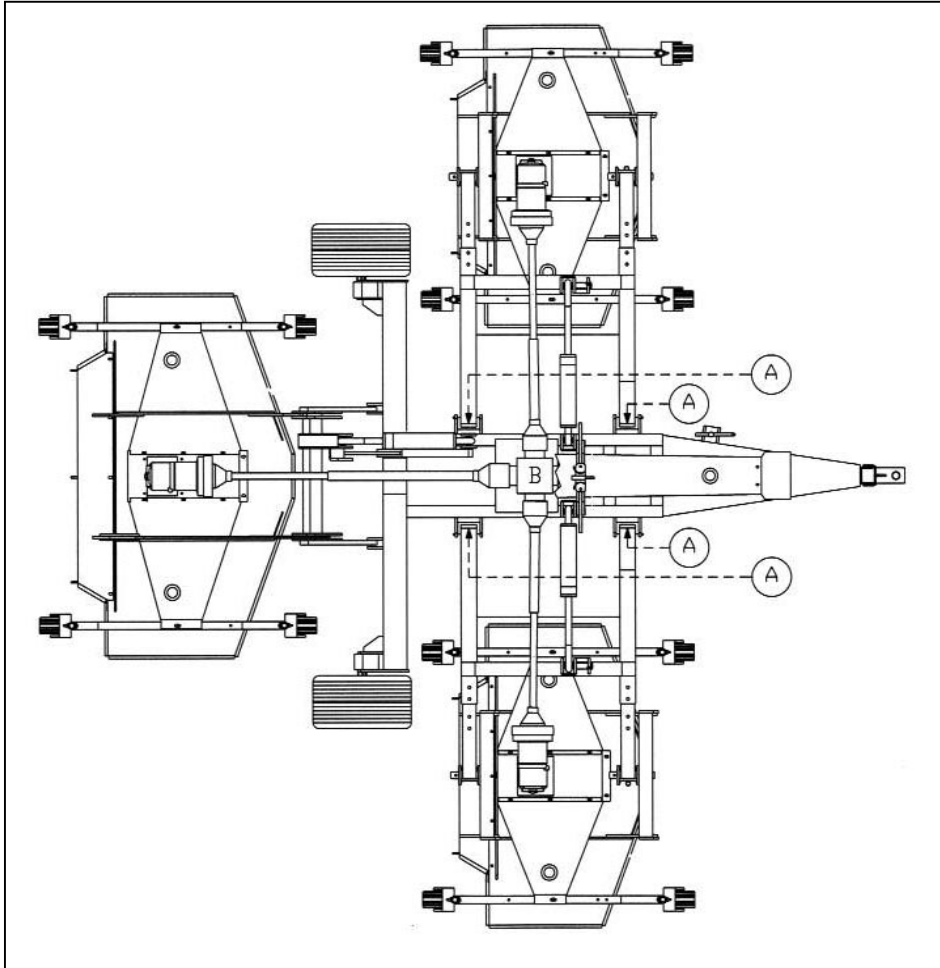

2. FRAME GEAR BOX OIL SUBSTITUTION

To change oil use only OIL SAE 90 EP, oil capacity of angular gear box is 0,5 L.

Oil change operations must be made at the terms scheduled on diagram "A".

a) To change oil in gear box "B" locate on main frame, operate as follow :

1. Remove safety protection.
2. Unscrew the plug locate on the top of gear box.
3. Unscrew discharge plug locate on lower part of gear box and take out oil.
4. Screw discharge pug.
5. Fill new oil in suitable type and quantity.
6. Screw the plug.
7. Put in place safety protection.

3. MOWERS GREASING

All the greasing points, both those situated and both centralized, are equipped with greaser HYDRAULIC TYPE MODEL "A" UNI 7663.

To grease use only MULTIFUNCTIONAL GREASE LITHIUM BASED Type NLGI 2.

Refer to diagram, greasing points are points "C" one per each wheel, point "D" located on a bracket in front of gear box bracket.

Greasing operation must be made at the terms scheduled on diagram "A".

4. MOWERS OIL CECK – OIL SUSTITUTION

To fill and to change oil use only OIL SAE 90 EP, oil capacity of angular gear box is 0,5 L.

Oil fill and oil change operations must be made at the terms scheduled on diagram "A".

a) To check oil level in angular gear box operate as follows :

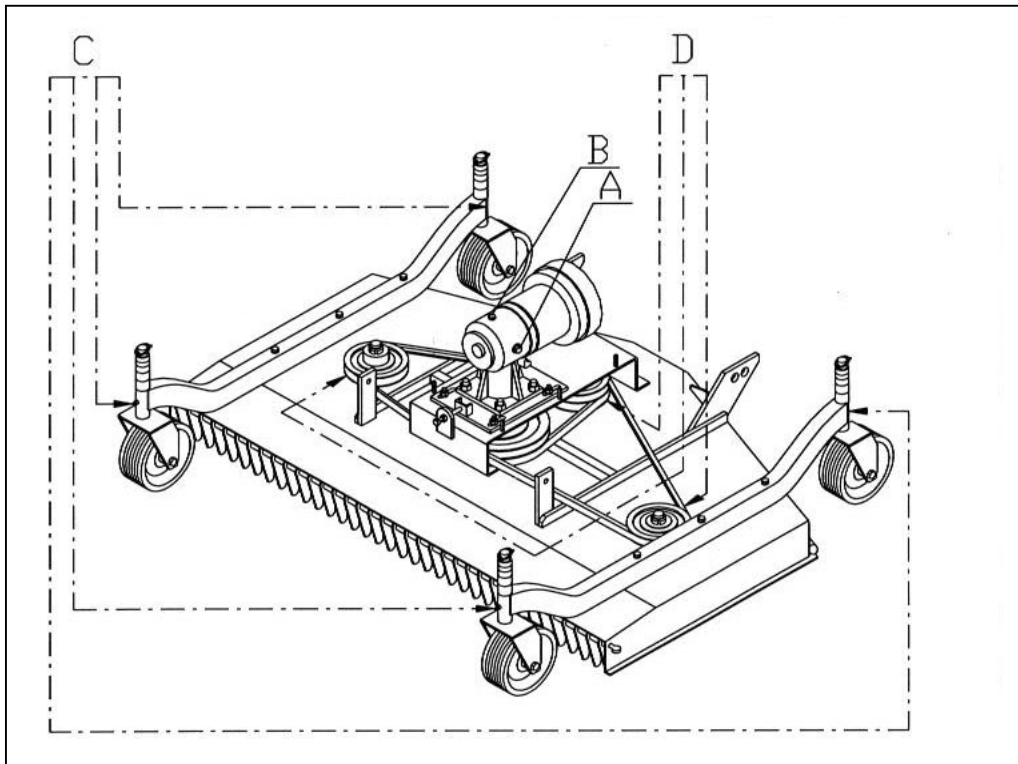

1. With the cutting machine on level, unscrew level plug "A", then check that oil touches on lower hole rim.
2. If level it's ok screw the plug "A".
3. If level it's low unscrew plug "B" and fill oil.
4. When level it's ok screw plugs "A" and "B".

b) To change oil in angular gear box operate as follows :

1. Unscrew plugs "A", "B".
2. Take away oil through hole "B" using a suitable little pump.
3. Put new oil through plug "B".
4. When level it's ok screw plugs "A" e "B".

5. BELTS ADJUSTING AND SUBSTITUTION

To adjust the tension or substitute the trapezoidal transmission belts operate as follows :

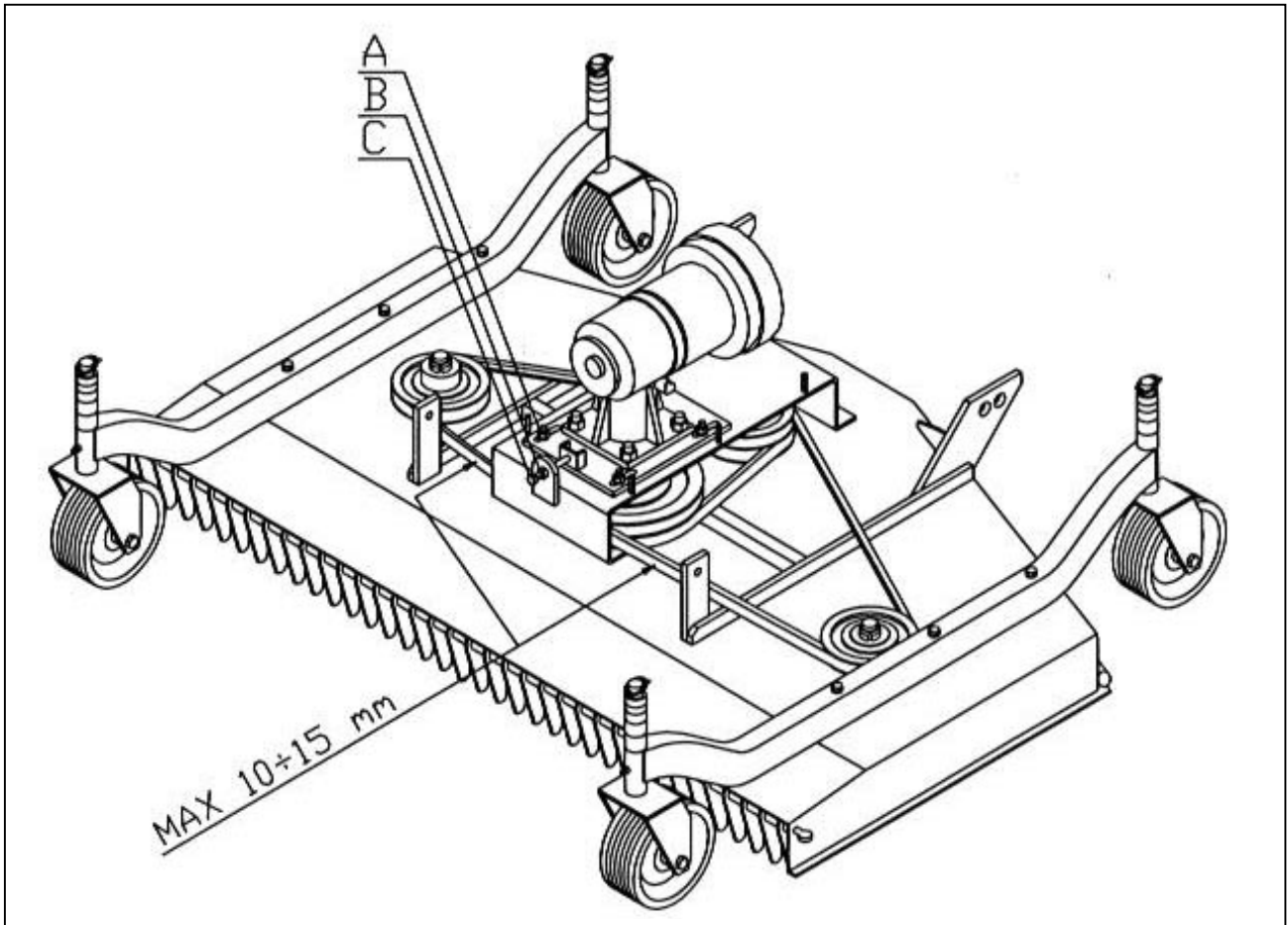

- a) Remove the two upper protection of the cutting component unlocking the fixing screws.
- b) Unlock the 4 screws "A" and nut "B".
- c) To substitute the belts, turn the screw "C" in counter clockwise direction.
- d) Remove the old belt and substitute it with a new one referring to the characteristics in the SPARE PART LIST.
- e) Turn the screw "C" in clockwise direction until to obtain the required tension. The best tension is when pushing with a hand on the belt, this subsides of 10-15 mm, screw nut "B".
- f) To adjust only the tension of the belt, don't read step "d".
- g) Lock the screws "A".
- h) Reassemble the protection.

6. BLADES SUBSTITUTION

To substitute the blades or to make operations of sharpness and/or balance, refering operate as follows:

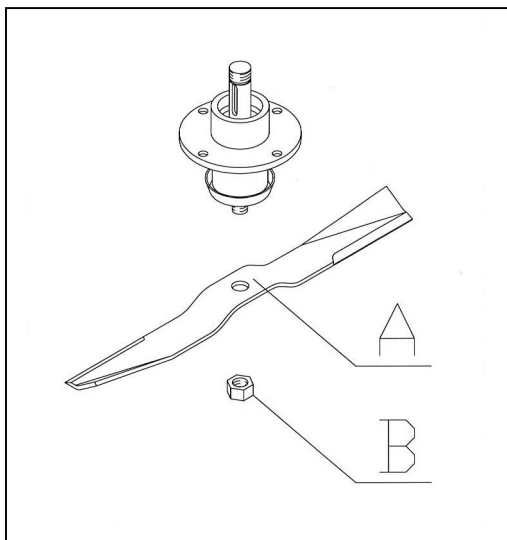

- a) Bring mower in raised position and make sure that the transmission be disconnected.
- b) Take stopped the blade with one hand.
- c) Unscrew the stop ring nut "B".
- d) Remove the blade "A" from its seat and substitute it with a new one or make the operations of sharpness and balance.
- e) Insert the new blade "A" in its seat.
- f) Take stopped the blade with one hand.
- g) Screw the stop ring nut "B" making sure to lock it very much.

PROBLEMS SOLVING

TROUBLES	GROUNDS AND SOLUTIONS
Abnormal vibrations	-Damaged blade - Replace -Broken blade - Replace -Not balanced blade - Balance -Damaged bearings – Change -Damaged hub - Change
Uneven or unsatisfactory cut	-Not sharp blade - Sharp

TRANSPORT

Except when working, moving the machine takes place when the machine is standing still and the transmission is disconnected.

<Important>: keep speed low avoiding holes and ground roughness.

<Important>: Before begin the movements always make sure that the safety hooks be in position.

<Note when on the road>, obey existing traffic laws. Exhibit the signal signs on the rear ends. Respect any local laws there may be.

STORAGE

Store the machine in a dry place that isn't dusty.

INFORMATION ON DEMOLITION



At the end of its working life, the machine must be sent to be demolished and that can only be done by an authorized authority, in accordance with the national laws in force for the environment. Therefore it is necessary to get information from the qualified local authorities on the procedure to follow. The machine is mainly composed of : iron materials and paints.

WARRANTY

The machine is covered by the manufacturer warranty for a period of 24 months.

The warranty is not applicable when :

- a) The maintenance work has not been done correctly.
- b) The machine has been used out of its own service.
- c) The machine has been transformed or modified without the manufacturer's written authorization.

SPARE PARTS & OPTIONS